

QUICK Start - Operator selection in Pro Series with white SIM

We highly recommend that you select several operators for your device, in order to spread the stream over several networks and avoid the risk of using a single network already overloaded.

Configuration per modem / SIM (3 modes)			Front Panel UI	Web UI
	Automatic	The operator is automatically selected in the field. <i>All SIM cards may lock on the same operator.</i>	<input checked="" type="checkbox"/>	<input checked="" type="checkbox"/>
	Scan & Select	The user scan the network in the field and select the expected operator among detected networks.	<input checked="" type="checkbox"/>	<input checked="" type="checkbox"/>
Manual	The user forces the operator (prior to field presence) with codes identifying the country (<i>Mobile Country Code</i>) and the operator (<i>Mobile Network Code</i>)	<input type="checkbox"/>	<input checked="" type="checkbox"/>	

Configuration from the front panel UI

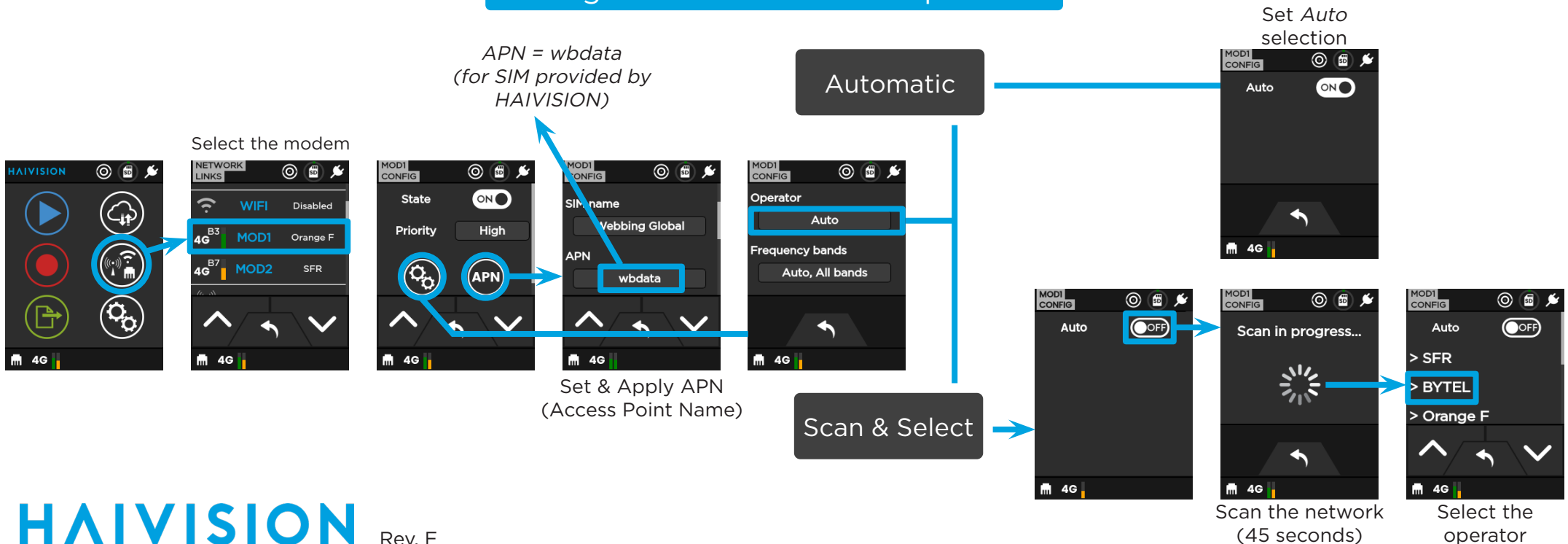

Configuration from the Web UI

Network	Status	Tx bitrate	Priority
ETH1	10.50.1.6	36.6 kbps	
ETH2	No link	0 bps	
WIFI	Disabled	0 bps	<input type="checkbox"/>
B20 4G MOD1	Orange F	0 bps	<input checked="" type="checkbox"/>

Select the modem

APN

Choose a pre-defined modem APN ▾

Name: Webbing Global

APN: wbdata

Username: _____

Password: _____

Operator: _____

APN = wbdata
(for SIM provided by Haivision)



Operator

Selection mode: Auto

Operator

Selection mode: Scan and select

Operator: Scan in progress... Scan

Scan the network
(45 seconds)

Operator

Selection mode: Scan and select

Operator:

Name	Orange	Scan
	<input checked="" type="checkbox"/> BYTEL	
	<input type="checkbox"/> Free	
	<input type="checkbox"/> SFR	

Select the operator

Operator

Selection mode: Manual

Name: BYTEL

MCC: 208 ?

MNC: 20 ?

All country/network codes
<http://www.mcc-mnc-list.com>

Set MCC
(Mobile Country Code)
Ex: 208 for France

Set MNC
(Mobile Network Code)
Ex: 01 for Orange
10 for SFR
15 for Free
20 for Bouygues Telecom

Apply